

**2022 Southwest/Southeast/Northwest
Division III District Wrestling Championships
Coaches Information
Friday, March 4th & Saturday, March 5th, 2022**

Site: Hobart Arena
255 Adams St.
Troy, OH 45373

Friday, March 4, 2022

**DOORS WILL OPEN @ 12:00 FOR
PARTICIPANTS**

DO NOT ARRIVE PRIOR TO NOON AND EXPECT TO GAIN ACCESS

12:00-1:00pm	Check-in all teams and coaches
1:00pm	Weigh-ins The entire Arena grounds are deemed the weigh-in area.
2:30pm	Coach's meeting (updated brackets)

DOORS OPEN TO THE PUBLIC AT 2:00PM

3:00pm	First round begins
5:30pm***	Wrestling continues (second round championship and first round consi) (approx.)
Weigh- Outs	Weigh-outs begin after the last match of the second round 144 lb. weight class, and end 1/2 hour after the last match of the 2 nd round

Saturday, March 5, 2022

8:00-9:00am

Check-in all teams and coaches

8:30-9:00

Weigh-ins for any wrestler who failed to weigh-out
Friday

DOORS OPEN TO THE PUBLIC AT 9:00AM

10:00am

Wrestling resumes

3:30pm***

Finals Begin No Earlier than 3:30

****Approximate times---We do not know the exact ending time of each round*

Admission:

Tickets can only be purchased at hometownticketing.com

Fri: \$ 8.00, price goes up to \$10 the day before

Sat: \$8.00, price goes up to \$10.00 the day before

Programs:

Will be available for \$2.00 with brackets included. Cash Only please.

Tournament Apparel:

District wrestling apparel will be available. Cash Only please.

Facilities:

Limited locker space is available. Bring a lock or keep valuables with you.

Assignments for locker rooms are as follows:

Locker Room #1 – Teams from Lehman Sectional

Locker Room #2 - Teams from Lima CC Sectional

Locker Room #3 – Teams from Reading Sectional

Locker Room #4 – Teams from Covington Sectional

Awards:

Team trophies will be presented to the Champion and Runner-up teams.

District medals will be awarded to the top six placers in each weight class.

Recipients must be in school issue uniform at the awards ceremony; no
jeans or hats

State:

Four wrestlers from each weight class and an alternate will qualify for the State
Tournament to be held March 11-13, 2022 at the Schottenstein Center.

2022 OHSAA Regulations:

Please review these regulations prior to the tournament paying special attention to the ALTERNATE information.

[WRindTourneyRegs.pdf \(windows.net\)](#)

Trainer:

An assigned, on-site athletic trainer will be available throughout the meet. A doctor will be available for skin check.

Coaches and Passes:

Each school will receive the following number of tickets:

1-6 Qualifying wrestlers 4 tickets

7-10 Qualifying wrestlers 5 tickets

11+ Qualifying wrestlers 6 tickets

These tickets are for coaches, managers, stats, bus driver, and support personnel who arrive with the team.

Cheerleaders---a maximum of 6 IN UNIFORM, will be admitted and they must be accompanied by their advisor.

Dress Code:

The Tournament Dress Code will be enforced at the Districts. Wearing of jeans, t-shirts, sweat suits, warm-up suits, headwear, flip, flops, sandals, and similar apparel is not considered suitable. Coaches who are inappropriately dressed will not be allowed on the competition floor.

Contestant:

Each team will need to pick up an envelope at the pass gate upon arrival. The envelope will contain tickets for the qualifying wrestler, coaches/support personnel based on district policy (see "Coaches and Passes" section above).

Parking:

Parking for teams will be at the Troy City Park across Adams Street just to the west of Hobart Arena. See the map that accompanies this information. This is parking for teams only---space is limited! Busses may drop off wrestlers at the Pass Gate, then park at the Troy City Park. Signs will be posted.

Check-in:

To enter, each wrestler will need to present their ticket at the pass gate on both Friday and Saturday.

**If for any reason a wrestler needs to leave the building during the competition, they must have their hand stamped for re-entry.

Re-Entry:

Wrestlers, stats, and coaches must enter and exit through the Pass Gate on the northeast side of Hobart Arena. Your hand must be stamped to gain re-entry to the arena. Please try to keep this to a minimum and stress with your fans/parents that there is NO RE-ENTRY ALLOWED FOR SPECTATORS!

Alternates:

Alternates must purchase a hometownticket®. If they wrestle, a refund will be issued.

Floor Access:

The only persons permitted in the wrestling area will be the wrestler and up to two coaches. Media with approved credentials will also be permitted on the floor. No stats will be allowed on the floor.

Pictures/Video: There will be NO pictures/video from the Arena floor without official Press Credentials!

Statisticians:

Statisticians are considered support personnel and may use one of the pass gate tickets allocated to your team. Stats are not allowed in the wrestling area. They should take stats from their seats, NOT STANDING OR SITTING AT THE WALL/EDGE OF THE FLOOR.

Bus Drivers:

Bus drivers will need a hometownticket® or a ticket from the coach's packet (see Coaches and Passes" above) to enter. **After drop-off of wrestlers at pass gate, busses are to park across Adams street from the Arena in the Troy Park.**

Concessions:

There will be a full concession stand for wrestling fans and participants. NO outside food for spectators will be permitted!

Hospitality:

Hospitality is a perk that is not provided by all districts. Food and refreshments for coaches will be limited and monitored. Please be respectful of hospitality workers. Hospitality will be a walk-through format. Hospitality is located in the Multi-Purpose Room on the northwest side of the arena (marked on the map included). Hospitality tickets will be provided in your check-in packet, quantities as follows...

2 for 1-6 participating wrestlers

3 for 7-10 participating wrestlers

4 for 11+ participating wrestlers

Hospitality will be open:

Friday from 1:00-3:00 (lunch only)

Saturday brunch 8:30-10:00, then dinner 2:30-4:30

Lodging:

There are several hotels nearby that have been recommended by the staff at Hobart Arena. They are:

Holiday Inn Express
60 Troy Town Drive
Troy, OH 45373 (937)-332-1700

Hampton Inn
45 Troy Town Drive
Troy, OH 45373 (937)-339-7801

Fairfield Inn
83 Troy Town Drive
Troy, OH 45373 (937)-332-1446

Residence Inn
87 Troy Town Drive
Troy, OH 45373 (937)-332-0257

We hope you have an enjoyable time at the tournament. We wish you and your wrestler(s) the best of luck. If you have any questions prior to or during the tournament,

Contact:

Dick Roll c:937-710-4052 w:937-498-1161 x135
r.roll@lehmancatholic.com

or

Brad Hall 937-238-0915
bhall@hartzellprop.com

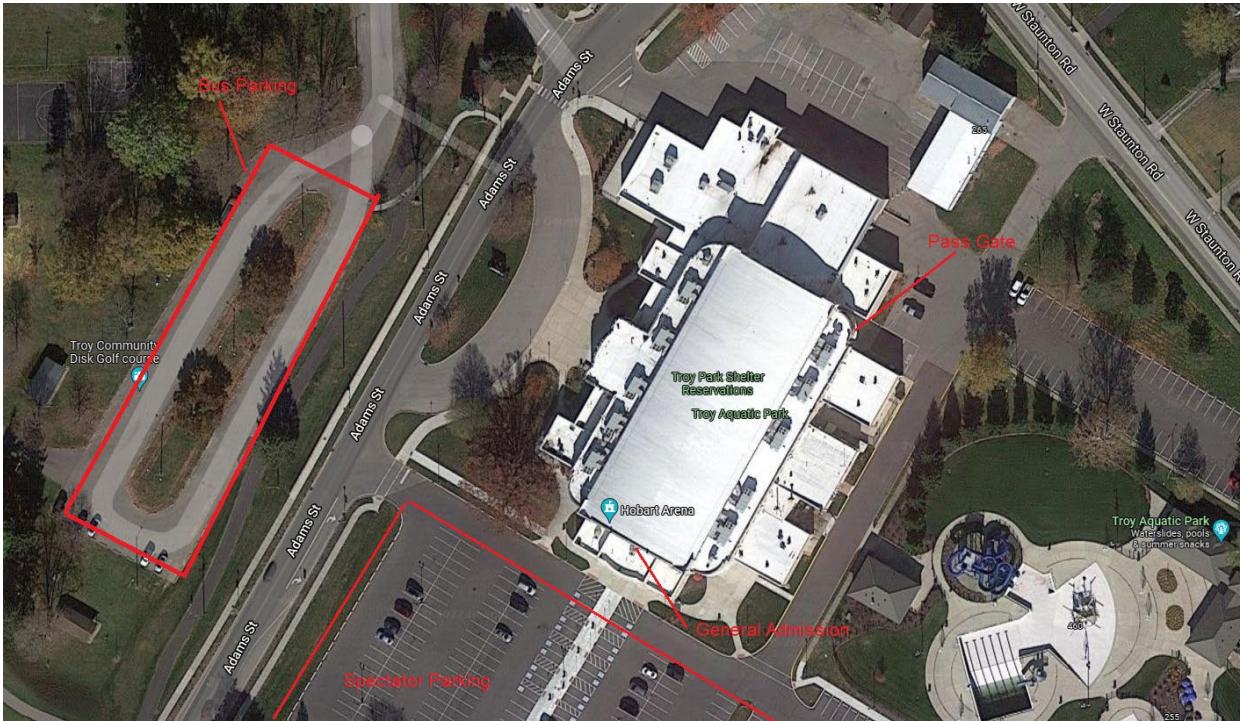

OHSAA Wrestling Meal Plan
Friday 3/4/22 & Saturday 3/5/22

Friday Lunch

1:00p – 3:00p *Coaches, Officials, and tournament staff*
Approximately 170 meals

- Pepperoni or cheese pizza and salad with shredded carrot, grape tomatoes, croutons, and shredded cheddar, assorted dressing packets
- Assorted Gatorades and bottled water

Saturday Breakfast

8:30a – 10:00a *Coaches, Officials, and tournament staff*
Approximately 150 meals

- Bacon, egg, and cheese bagel sandwich (hot), assorted muffins, apples, bananas, granola bars
- Apple juice, orange juice, bottled water

Saturday Lunch

2:30p – 4:30p *Coaches, Officials, and tournament staff*
Approximately 150 meals

- Cheeseburger with lettuce/tomato/onion/pickle, condiment packets, individual bag of Frito Lay's Classic chips, chocolate chip cookie
- Assorted Sodas and bottled water

All officials, coaches and staff will receive their colored tickets to use to redeem their meals. The coaches will receive their tickets with their coach's packets. Each meal will be identified by a different colored ticket and those tickets will be the only tickets accepted for that particular meal.

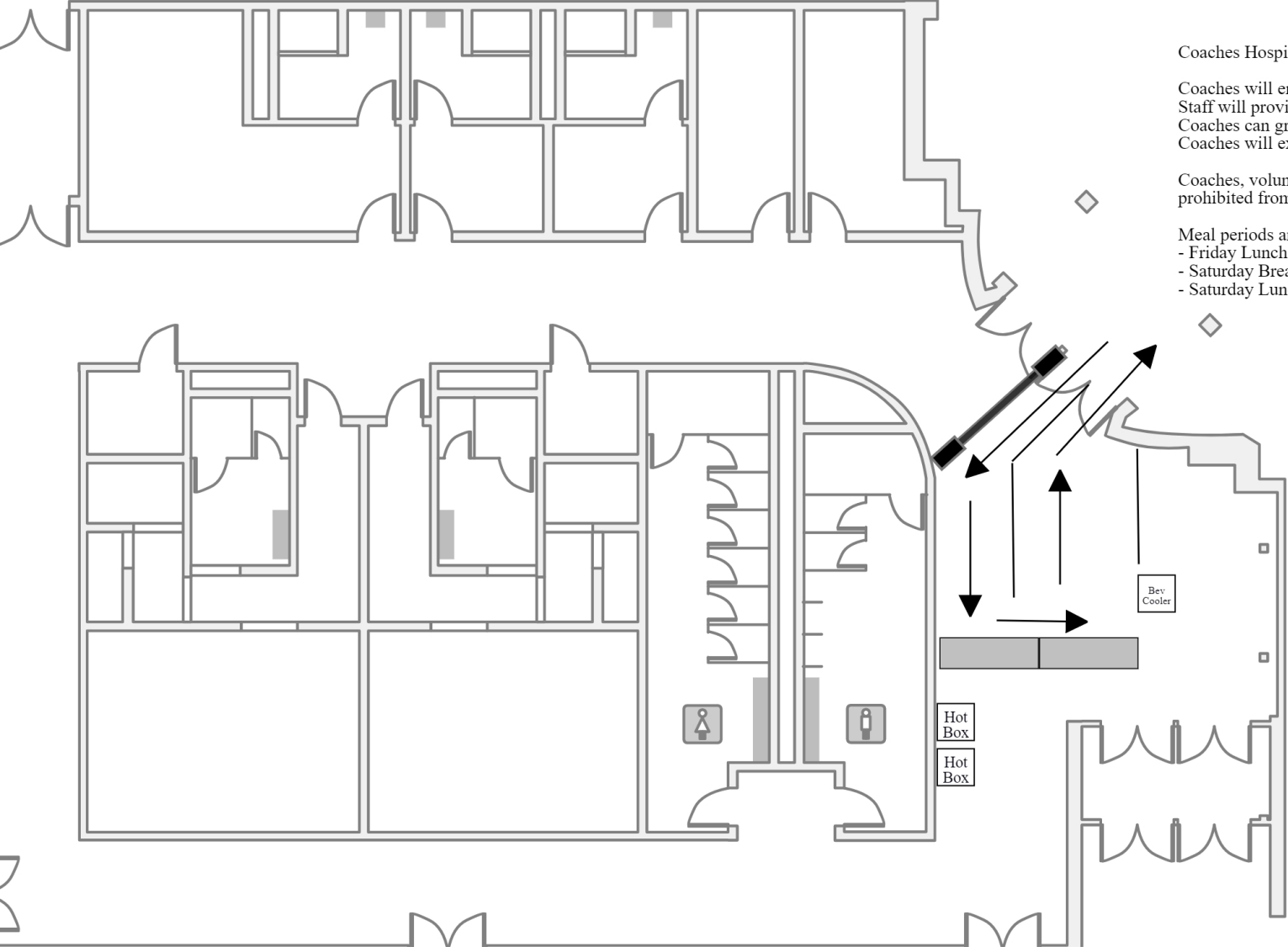

Coaches Hospitality 2021

Coaches will enter from corridor.
 Staff will provide food stuffs.
 Coaches can grab beverages from cooler.
 Coaches will exit foyer and return to stands.

Coaches, volunteers, and staff are prohibited from congregating in foyer.

- Meal periods and timeframes
- Friday Lunch 1p - 3p for 170
 - Saturday Breakfast 8:30a - 10a for 150
 - Saturday Lunch 2:30p - 4:30p for 150

Bev Cooler

Hot Box

Hot Box

